

INSTALLATION, OPERATION & MAINTENANCE MANUAL

Flanged ends
Ball float Steam Trap.



Ref. GENE BRE: 2287

INSTRUCTIONS FOR INSTALLATION, OPERATION & MAINTENANCE MANUAL

1. Spare Parts	3
1.1 Parts List	3
2. Transport and Storage conditions	4
3. Installation Instructions	5
3.1 Preparation	5
3.2 Installation	5
4. Maintenance Instructions	6
5. Repair Instructions	7
6. Safety Instructions	9

1) Spare Parts.

1.1) Parts list:

DN25 (Single Seat):

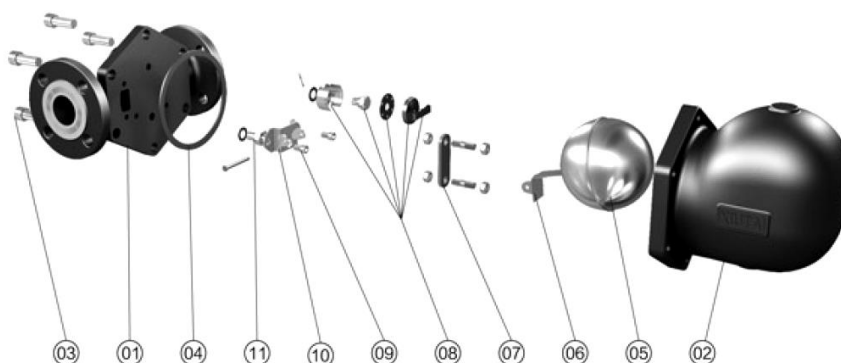

Nº	Name	Material
1	Body	Carbon Steel 1.0619 (WCB)
2	Cover	Carbon Steel 1.0619 (WCB)
3	Bolts	A193 B7
4	Gasket	Stainless Steel 304 + Graphite
5	Ball	Stainless steel
6	Lever	Stainless steel
7	Baffle	Stainless steel
8	Air vent	Stainless steel
9	Bolts	A193 B8
10	Bracket	Stainless steel
11	Seat	Stainless steel

DN40/50 (Double Seat):

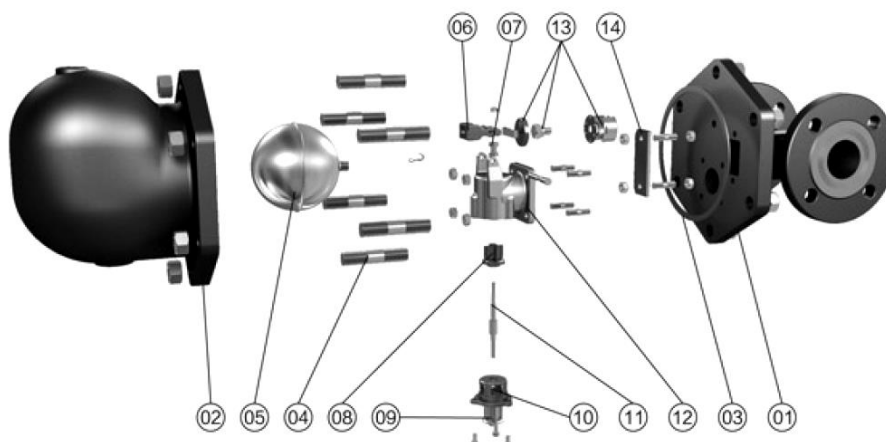

Nº	Nombre	Material
1	Body	Carbon Steel 1.0619 (WCB)
2	Cover	Carbon Steel 1.0619 (WCB)
3	Gasket	Stainless Steel 304 + Graphite
4	Bolts	A193 B7
5	Ball	Stainless steel
6	Bracket	Stainless steel
7	Seat (1)	Stainless steel
8	Guide (1)	Stainless steel
9	Guide (2)	Stainless steel
10	Seat (2)	Stainless steel
11	Stem	Stainless steel
12	Bolts	A193 B8
13	Air vent	Stainless steel
14	Baffle	Stainless steel

Genebre, S.A. offers a wide range of products designed and assembled to handle and drive fluids in industrial procedures.

The application of these products to the different industrial processes is at user's risk. The product will have an optimal behaviour when working conditions do not exceed pressure and temperature limits for which they have been designed. Please, refer to the product data sheet.

2. Transport and Storage conditions



Transport and storage of this type of products must be done in their original package

VISUAL INSPECTION

Check whether during transport, unloading and placement products have suffered any damage.



If you notice any kind of anomaly during reception of the goods, contact immediately with GENE BRE in order to determine the possible responsibilities on the issue.

In case that the product is not installed immediately, keep it with protective packaging to prevent strokes or accumulation of dirt (it should not be removed until the product is going to be installed). As far as possible, the product should be stored in a dry and clean area

IMPORTANT NOTE:

Before installing and/or manipulating these elements **READ CAREFULLY** the enclosed instructions for use and **OBSERVE** all contained information. If any of the contents is not clear enough, please **contact GENE BRE, S.A.**



User is responsible for the safe use of these products, as established in present instructions for use and in the specific technical documentation of the supplied device.

3) Installation Instructions

3.1) Preparation

Remove any remaining packing materials from the trap.

There may be serious problems with any accessory installed in a dirty pipe.

Make sure the pipe is free of dirt, welding particles, etc. before installations because the accessory could get irreparable damage when starting-up → prepare a *clean working area*. Provide enough space for future maintenance.

3.2) Installation

Use flat gaskets between steam trap and pipe flanges to ensure sealing.

The steam traps are designed for mounting between flanges EN 1092 PN16.

Check the parallelism of the flanges. Keep enough space between them so that the steam trap can be inserted or removed easily.

Tighten the screws of the flanges to hold the steam trap firmly. Apply the alternate clamping method to ensure proper installation.

IMPORTANT:

Pay special attention to the flow direction of the steam trap marked by an arrow in the body.



The trap must be installed with the buoy in a horizontal plane so that the movement is vertical, the arrow indicated on the cover indicate the installation position.



If the trap has free discharge into the atmosphere, take extreme precautions because a bad operating procedure could cause a serious accident to you or to the installation system.

4) Maintenance instructions



It is responsibility of the user to establish a plan of inspection and maintenance of these apparatuses with the purpose of guaranteeing its safe use.

The inspections must be made only by qualified personnel, in accordance with the type of equipment and installation required.

Frequency, location and process of maintenance will be determined by the user by taking into account usage of the product.



Before disassembling the pipe's steam trap to repair or replace it, make sure that line has been closed and depressurized because a bad operational procedure could cause a serious accident to you or to the installation system

Prepare a clean working area and appropriate tooling for mechanical tasks.

5) Repair Instructions.

5.1) Main valve:

DN25 (Single Seat):

Disassembly:

- a. Loosen and remove the bolts (part.3).
- b. Remove the cover (part.2) and the gasket (part.4).
- c. Remove the ball and lever (part.5 and 6).
- d. Loosen and remove the bolts (part.9) and the support (part.10).
- e. Loosen and remove the seat and gasket (part.11).
- f. Clean the all componets with compressed air or another method.

Assembly:

- a. Place the new seat and gasket (part.11) and tighten.
- b. Place the support (part.10) and tighten with the bolts (part.9)
- c. Place the new ball and lever (part.5 and 6).
- d. Place new gasket (part.4).
- e. Place the cover (part.2).
- f. Place the bolts (part.3) to assembly on the body (part.1).
- g. Then, tighten the bolts (part.3) adjusting slowly and alternating diagonally.

DN40/50 (Double Seat):

Disassembly:

- a. Loosen and remove the bolts (part.4).
- b. Remove the cover (part.2) and the gasket (part.3).
- c. Loosen and remove the bolts (part.12).
- d. Remove the main valve assembly (part. 5,6,7,8,9,10,11).
- e. Clean the all componets with compressed air or another method.

Assembly:

- a. Place the new main valve assembly (part.5,6,7,8,9,10,11).
- b. Place the bolts (part.12) and tighten.
- c. Place new gasket (part.3).
- d. Place the cover (part.2).
- e. Place the bolts (part.4) to assembly on the body (part.1).

-
- f. Then, tighten the bolts (part.4) adjusting slowly and alternating diagonally.

5.2) Air vent:

DN25 (Single Seat):

Disassembly:

- a. Loosen and remove the bolts (part.3).
- b. Remove the cap (part.2) and the gasket (part.4).
- c. Remove the air vent assembly (part.8).
- d. Clean the all componets with compressed air or another method.

Assembly:

- a. Place the new air vent assembly and gasket (part.8).
- b. Place new gasket (part.4).
- c. Place the cover (part.2).
- d. Place the bolts (part.3) to assembly on the body (part.1).
- e. Then, tighten the bolts (part.3) adjusting slowly and alternating diagonally.

DN40/50 (Double Seat):

Disassembly:

- a. Loosen and remove the bolts (part.4).
- b. Remove the cap (part.2) and the gasket (part.3).
- c. Remove the air vent assembly (part.13).
- d. Clean the all componets with compressed air or another method.

Assembly:

- a. Place the new air vent assembly and gasket (part.13).
- b. Place new gasket (part.3).
- c. Place the cover (part.2).
- d. Place the bolts (part.4) to assembly on the body (part.1).
- e. Then, tighten the bolts (part.4) adjusting slowly and alternating diagonally.

6) Safety Instructions

6.1) The fluids pass through a valve or accessory can be corrosive, toxic, flammable or pollutant. They can also be found at very high or low temperature. When handling valves or accessory shall be taken necessary security measures and it is advisable to use personal protective equipment:

- 1) Wear eye protection.
- 2) Wear gloves and appropriate work clothes.
- 3) Wear safety shoes.
- 4) Wear a helmet.
- 5) Note the availability of running water.
- 6) For flammable fluids, make sure you have a fire extinguisher.

6.2) Before removing a valve or accessory from a pipe, always check that the line is completely cold, drained and depressurized.

6.3) Any valve or accessory that was used in toxic services must have a cleaning certificate before handling.

6.4) Any type of repair or maintenance should be performed in ventilated places.